

MATCHLINE (See Sheet IR-3)

MATCHLINE (See Sheet IR-5)

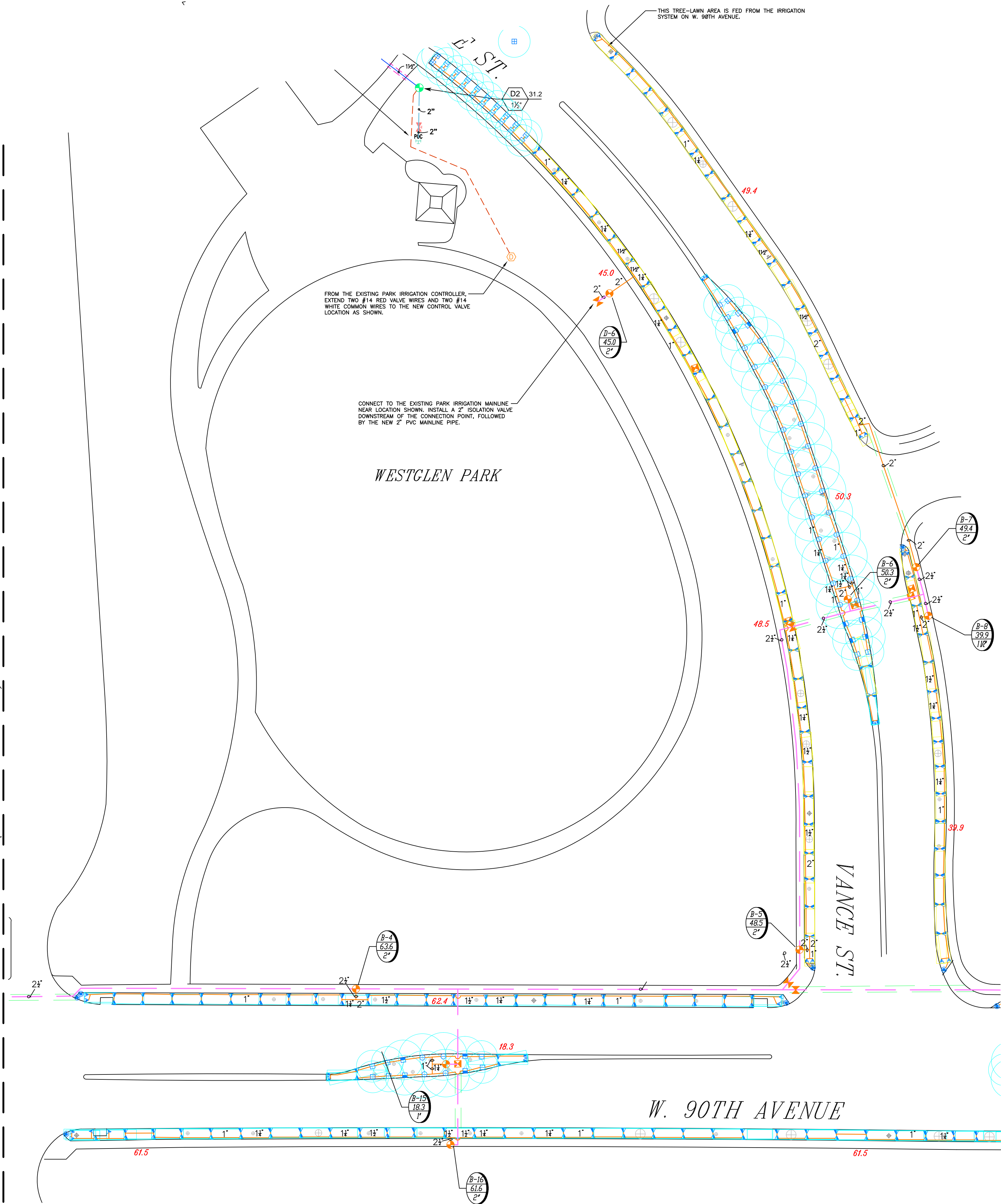

SYMBOL	DESCRIPTION	DETAIL #
(A)	IRRIGATION CONTROLLER - PEDESTAL MOUNT CONTROLLER: 32 STATION RAIN BIRD ESP-LXME SERIES WITH WR2 SERIES WIRELESS RAIN/FREEZE SENSOR. ALTERNATE CONTROLLER: 32 STATION WEATHERMATIC SMARTLINE SERIES WITH SMARTLINK MODEM, SLW5 WEATHER STATION AND SLFSI-T FLOW SENSOR.	1
(M)	WATER METER - 1" (EXISTING)	
(X)	BACKFLOW PREVENTER: 1" PVB PRESSURE VACUUM BREAKER INSTALLED 12" ABOVE THE HIGHEST DISCHARGE POINT OF THE SYSTEM. (EXISTING)	2
(S)	WEATHERMATIC 1-1/2" FLOW SENSOR, MODEL #SLFSI-T15, INSTALLED IN A VALVE BOX.	
(I)	ISOLATION VALVE: LASCO SLO-CLOSE BALL VALVE OR APPROVED ALTERNATIVE, LOCATE IN 10" ROUND VALVE BOX.	
(H)	HUNTER ICV SERIES ELECTRIC MASTER VALVE, 1-1/2" INSTALLED IN A VALVE BOX.	3
(H)	HUNTER ICV SERIES ELECTRIC CONTROL VALVE INSTALLED IN A VALVE BOX. SIZE SHOWN ON PLANS.	4
(- - -)	(EXISTING) SOFT COPPER MAIN FROM THE WATER METER TO THE BACKFLOW PREVENTER. SIZE SHOWN ON PLANS.	
(- - -)	CL-200 BE PVC MAINLINE W/ 3/4" MANUAL DRAIN VALVES INSTALLED AT ALL LOW POINTS OF MAINLINE. SIZE SHOWN, 18" MINIMUM DEPTH.	5
(- - -)	CL-200 BE PVC LATERAL. SIZE AS SHOWN, 8" MINIMUM DEPTH.	5
(- - -)	BLU-LOC 1/2" SWING PIPE 8" MINIMUM DEPTH.	
(- - -)	(EXISTING) LATERAL LINES AND ZONE CONFIGURATIONS.	
(A-7)	VALVE NUMBER	
(135)	FLOW RATE	
(1")	VALVE SIZE	

IRRIGATION HEADS

SYMBOL	DESCRIPTION	DETAIL #
(A)	RAINBIRD 1804-SAM-PRS SERIES POP-UP SPRAY HEAD WITH HUNTER 5x15-LCS SERIES NOZZLE	6
(A)	RAINBIRD 1804-SAM-PRS SERIES POP-UP SPRAY HEAD WITH HUNTER 5x15-RCS SERIES NOZZLE	6
(A)	RAINBIRD 1804-SAM-PRS SERIES POP-UP SPRAY HEAD WITH HUNTER 5x30-SST SERIES NOZZLE	6
(A)	RAINBIRD 1804-SAM-PRS SERIES POP-UP SPRAY HEAD WITH 4x15-LCS STRIP SERIES NOZZLE	6
(A)	RAINBIRD 1804-SAM-PRS SERIES POP-UP SPRAY HEAD WITH 4x15-RCS STRIP SERIES NOZZLE	6
(A)	RAINBIRD 1804-SAM-PRS SERIES POP-UP SPRAY HEAD WITH 4x30-SST STRIP SERIES NOZZLE	6
(A)	RAINBIRD 1804-SAM-PRS SERIES POP-UP SPRAY HEAD WITH 5" MPR SERIES SPRAY NOZZLE	6
(A)	RAINBIRD 1804-SAM-PRS SERIES POP-UP SPRAY HEAD WITH 8" U OR HE-VAN SERIES NOZZLE	6
(A)	RAINBIRD 1804-SAM-PRS SERIES POP-UP SPRAY HEAD WITH 10" U OR HE-VAN SERIES NOZZLE	6
(A)	RAINBIRD 1804-SAM-PRS SERIES POP-UP SPRAY HEAD WITH 12" U OR HE-VAN SERIES NOZZLE	6
(A)	RAINBIRD 1804-SAM-PRS SERIES POP-UP SPRAY HEAD WITH 15" U OR HE-VAN SERIES NOZZLE	6
(A)	RAINBIRD 1804-SAM-PRS SERIES POP-UP SPRAY HEAD WITH VAN OR HE-VAN SERIES NOZZLE	6

IRRIGATION NOTES:

- 1) ALL BASE INFORMATION HAS BEEN TAKEN FROM DRAWINGS PREPARED BY WESTERN WATER MANAGEMENT, LLC
- 2) LOCATE ALL UTILITIES PRIOR TO EXCAVATION. CONTRACTOR SHALL BE RESPONSIBLE FOR DAMAGE TO UTILITIES DURING THE INSTALLATION OF THE IRRIGATION SYSTEM.
- 3) ALL PROPERTY OR UTILITY DAMAGES ARE THE RESPONSIBILITY OF THE INSTALLING CONTRACTOR
- 4) ALL PERMITS, PRIVATE LOCATES AND STREET CLOSURE COSTS WILL BE THE RESPONSIBILITY OF THE CONTRACTOR
- 5) CONTRACTOR SHALL USE DIRECTIONAL BORING OR HAND EXCAVATION TO PROTECT TREE FEEDER ROOTS.
- 6) CONTRACTOR SHALL INSTALL SEED IN ALL DISTURBED AREAS.
- 7) CONTRACTOR SHALL FIELD VERIFY PRESSURE FOR EACH TAP PRIOR TO STARTING IRRIGATION INSTALLATION AND NOTIFY CONSULTANT OF ANY DIFFERENCE FROM STATED PRESSURE. CONTRACTOR ASSUMES FULL RESPONSIBILITY FOR ANY SYSTEM ALTERATIONS IF CONSULTANT IS NOT NOTIFIED. THE WEST 90TH AVE. SYSTEM HAS BEEN DESIGNED FOR A MINIMUM STATIC PRESSURE OF 46PSI UPSTREAM OF THE BACKFLOW PREVENTER.
- 8) CONTRACTOR SHALL COORDINATE INSTALLATION OF SLEEVING WITH IRRIGATION INSTALLATION. SLEEVING IS PROVIDED BY CONTRACTOR UNLESS OTHERWISE NOTED. SIZE SLEEVING AS FOLLOWS:

PIPE SIZE OR # OF WIRES	SLEEVE SIZE
1"-1.25"	2" CL-200 PVC
1.5"-2"	4" CL-200 PVC
2.5"-3"	6" CL-200 PVC
4"-50 CONTROL WIRES	2" CL-200 PVC
26-70 CONTROL WIRES	3" CL-200 PVC
- 9) CONTROLLER SHALL BE SET TO OPERATE ONE VALVE AT A TIME
- 10) INSTALL ALL EQUIPMENT PER MANUFACTURER'S INSTRUCTIONS & RECOMMENDATIONS. REFER TO TECHNICAL SPECIFICATIONS AND CONSTRUCTION DETAILS FOR INSTALLATION PROCEDURES.
- 11) ALL CONSTRUCTION IS TO ADHERE TO CITY OF WESTMINSTER STANDARDS & SPECIFICATIONS.
- 12) BRAND VALVE BOX LIDS WITH CONTROLLER LETTER AND VALVE NUMBER AS SHOWN ON PLANS. FOR QUICK COMPARES USE "Q" AND FOR ISOLATION VALVES USE "I".
- 13) COMPACT ALL TRENCHES TO THE SAME DENSITY AS THE ADJACENT UNDISTURBED SOIL.
- 14) ADJUST IRRIGATION HEADS TO PROVIDE ADEQUATE COVERAGE AND MINIMIZE OVERSPRAY. ADJUST CONTROLLERS TO IRRIGATE USING REPEAT CYCLES TO REDUCE RUN-OFF.
- 15) EQUIPMENT SHOWN IN HARDSCAPE AREAS IS FOR DRAWING CLARIFICATION ONLY. INSTALL IN PLANTING AND TURF AREAS AS NECESSARY.
- 16) SPARE CONTROL WIRES - CONTRACTOR SHALL EXTEND THREE SPARE WIRES (ONE COMMON AND TWO CONTROL WIRES) FROM CONTROLLER B TO THE ENDS OF THE MAINLINE. USE #14 BLACK FOR SPARE COMMON AND #14 BLUE FOR SPARE CONTROL WIRES.
- 17) TURF WATER REQUIREMENTS WILL VARY FROM 1/2" TO 2" PER WEEK DEPENDING ON THE CLIMATE. ANNUAL SYSTEM WATER CONSUMPTION BASED ON ADJUSTED ET VALUES FROM PREVIOUS SEASONS IS 912,810 GALLONS. THE PRECIP. RATE OF THE HUNTER FIXED ARC NOZZLES ON THIS SYSTEM IS BETWEEN 1.8in/hr AND 1.95in/hr. TIME REQUIRED TO APPLY 1-INCH IS APPROXIMATELY 33 MINUTES. THE PRECIP. RATE OF THE PRECISION SPRAY HEADS ON THIS SYSTEM IS BETWEEN 1.0in/hr AND 1.2in/hr. TIME REQUIRED TO APPLY 1-INCH IS APPROXIMATELY 55 MINUTES.
- 18) PRIOR TO FINAL ACCEPTANCE BY THE METRO DISTRICT, THE INSTALLATION CONTRACTOR SHALL PROVIDE THE FOLLOWING:
 - SIGNED AND DATED WRITTEN DESCRIPTION OF THE CONTRACTOR'S WARRANTY AND WARRANTY PERIOD.
 - ALL PRODUCT LITERATURE AND CUSTOMER SERVICE INFORMATION FOR PRODUCTS USED/INSTALLED ON PROJECT.
 - CURRENT IRRIGATION SCHEDULES FOR ALL CONTROLLERS.

LEGEND: (Site Base Plan)

Symbol	Description
(E)	Existing - EVERGREEN TREE
(D)	Existing - DECIDUOUS TREE (small caliper)
(M)	Existing - DECIDUOUS TREE (med. caliper)
(L)	Existing - DECIDUOUS TREE (large caliper)
(P)	Utility Pedestal Location - Phone / Cable
(F)	Fire Hydrant
(S)	Street Light
(T)	STREET SIGN



WESTGLEN METRO DISTRICT
WEST 90TH AVENUE
IRRIGATION AS-BUILT

COPYRIGHT
 WESTERN WATER MANAGEMENT, LLC
 THESE PLANS ARE THE PROPERTY OF
 THE COMPANY AND SHALL NOT BE
 REPRODUCED, COPIED, OR
 TRANSMITTED IN ANY FORM OR BY
 ANY MEANS, ELECTRONIC OR
 MECHANICAL, INCLUDING PHOTOCOPYING,
 RECORDING, OR BY ANY INFORMATION
 SYSTEMS WITHOUT THE WRITTEN
 CONSENT OF THE DESIGNER.
 COPYRIGHTS AND INFRINGEMENTS WILL
 BE ENFORCED AND PROSECUTED.

DATE: JAN 16 2019
DRAWN BY: SL
CHECKED BY: LLB
JOB NUMBER:
ISSUE / REVISIONS:

SCALE
1"=30'

IR-4